

# Link arm door closers

## CT2500

CT2500 door closers stand out for their versatility and stylish design.

- » One model for three sizes: EN2, EN3 and EN4
- » Unique body and arm hole pattern for three sizes.
- » Maximum opening up to 180°
- » Sweep speed and latching speed fully adjustable with separate valves.
- » Backcheck valve to protect the door against violent openings.
- » CT2501: Includes adjustable hold open arm, for any door open position up to 180°.
- » Reversible, non handed.
- » Finishes: White (BL), Black (NE), Silver (PL).

EN 1154 CERTIFIED

Fire door



Classification according EN1154:1996+A1:2002

Standard arm transom mountings:

4 8 2/4 1 1 4

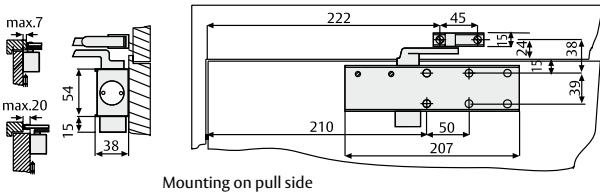
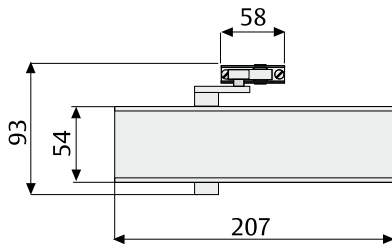
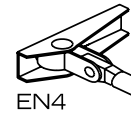

Mounting on pull side

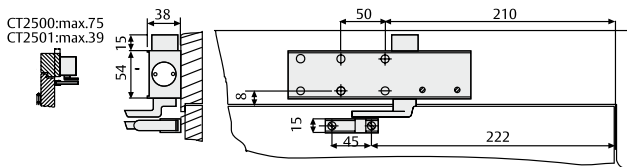

Mounting on push side

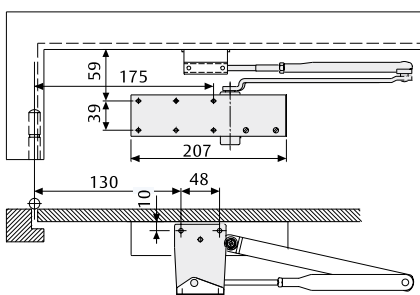

Size	Door Width cm	Door Weight Kg
2	85	40
3	95	60
4	110	80

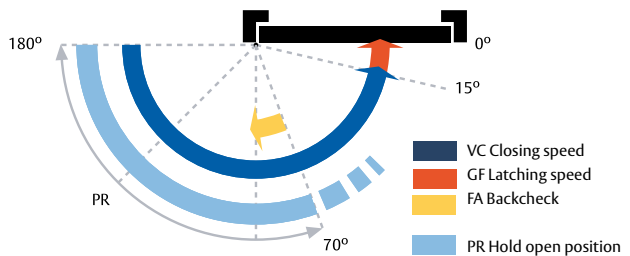

Non hold open (EN1154 Certified)		
Size	Model	Finish
2 - 4	CT250034BL	White
2 - 4	CT250034NE	Black
2 - 4	CT250034OR	Gold
2 - 4	CT250034PL	Silver

Hold open (Not suitable for fire doors)		
Size	Model	Finish
2 - 4	CT250134BL	White
2 - 4	CT250134NE	Black
2 - 4	CT250134OR	Gold
2 - 4	CT250134PL	Silver

Paralell arm installation bracket		
Model	Finish	
SOP2500BL	White	
SOP2500NE	Black	
SOP2500OR	Gold	
SOP2500PL	Silver	



The CT2500 and CT2501 are size 3 when paralell arm mounting is used.