

Floor springs

CTSU80

- » Floor spring with fixed closing force for very thin slabs
- » Certified in compliance with EN 1154, size 3 or 4
- » Suitable for fire and smoke protection doors
- » For double and single action doors up to 120 kg

Characteristics CTSU80

- » Same dimensions for 2 bodies according to fixed size EN3, EN4
- » Hydraulic control over 130° in both door swing directions
- » Adjustable door speed and latching speed from top regulating valves
- » Cast iron body
- » Adjustments in all directions within the cement box
- » Cement box hot zinc plated and only 40 mm high
- » Cover plates and eyelets made in polished or satin stainless steel
- » Interchangeable spindle from 0 + 30 mm
- » Available with hold-open at 90°, 105° and without hold-open

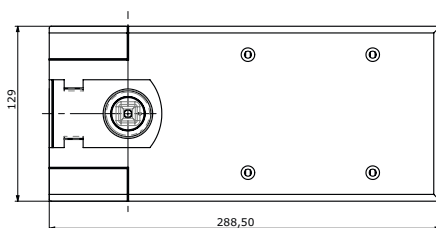
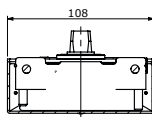
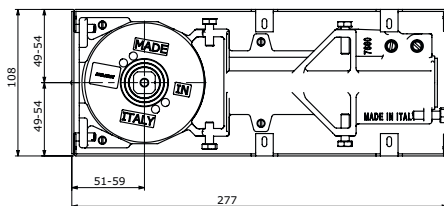
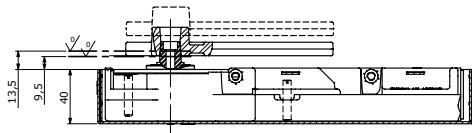

EN 1154 CERTIFIED
Fire door



Description	Product code
CTSU80 Floorspring size 3 without Hold-Open	CTSU803SRST
CTSU80 Floorspring size 3 with Hold-Open at 90°	CTSU803R0ST
CTSU80 Floorspring size 3 with Hold-Open at 105°	CTSU803R5ST
CTSU80 Floorspring size 4 without Hold-Open	CTSU804SRST
CTSU80 Floorspring size 4 with Hold-Open at 90°	CTSU804R0ST
CTSU80 Floorspring size 4 with Hold-Open at 105°	CTSU804R5ST
Cover Plate for CTSU80 Satin Stainless Steel	TACTSU80IM
Cover Plate for CTSU80 Polished Stainless Steel	TACTSU80IB
Detachable Italian Spindle h = 0 mm	PIC150
Detachable Italian Spindle h = 5 mm	PIC151
Detachable Italian Spindle h = 10 mm	PIC152
Detachable Italian Spindle h = 15 mm	PIC153
Detachable Italian Spindle h = 20 mm	PIC154
Reversible bottom arm in steel for double action doors. Socket for Italian Spindle	BRI300VHZ
Double action top pivot	BRS300VHZ
Bottom arm in steel for single action doors, 36 mm offset. Socket for Italian spindle. ABS cover in silver	BRI301PL
Right and left top arm in full steel, 36 mm offset. ABS cover in silver	BRS301PL