

ABLOY® KD210

Wall mounted key deposit housing



Product description
Can be outfitted with the CY190 cylinder.

- Overview of Advantages**
- Zinc coating
 - Product is tested and certified according to the most demanding standards SFS 5970, SFS 7020, FA security grade 3

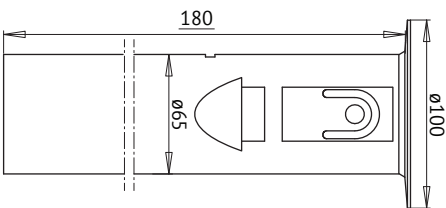

Technical data	
Available plating options	Zinc coating
Cylinder size	Diameter 65/100mm, lenght 180mm
	FA3
Weight	1.2kg

This content is protected by Intellectual Property Rights Laws. The title to the content shall not pass to you, and instead shall remain with Abloy Oy or a third party holding the title. Abloy develops continuously the products and solutions offered. Therefore, the information contained in the document is subject to change without notice. ABLOY PROVIDES THIS CONTENT ON AN "AS IS" BASIS WITHOUT ANY WARRANTIES OF ANY KIND, EXPRESS, IMPLIED, OR STATUTORY."