

Fire doors hardware

Hinges for certified firebreak doors

- » 3mm thick steel hinge for break doors. Reversible.
- » Certified according to EN1935:2002

UNE-EN 1935:2002 **4 7 5 1 1 0 0 12**

- » CE Grade 12 certified for 100 kgs doors and 200.000 cycles.
- » Includes 2 brass friction washers
- » Non plated

Product code	Dimensions
BISCFCE10ST	160x60x36
BISCFCE250ST	160x60x36

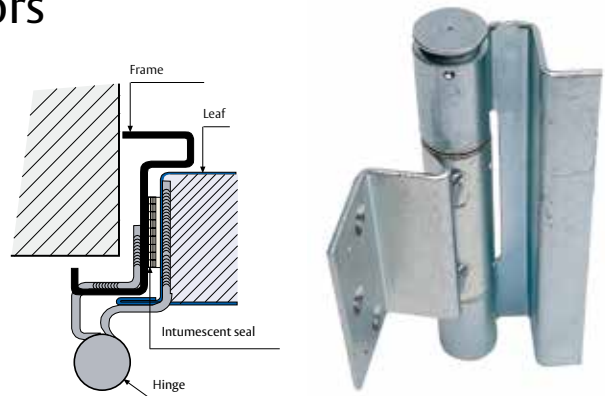

Stainless Steel hinge

- » Stainless Steel hinge with two ball bearings for break fire doors
- » Extremely corrosion resistance, Grade 4. Reversible.
- » CE Certified according to EN1935:2002

4 7 6 1* 1 4 0 13

Packing includes:

- » 1 pair of hinges
- » 16 Philips wood screws

Product code	Finishes	Dimensions
BISCFCE433IS16	IS16	102x76x3 mm
BISCFCE443IS16	IS16	102x102x3 mm

Product code	Finishes	Dimensions
BISCFCEM433IS*	IS304	102x76x3 mm
BISCFCEM443IS*	IS304	102x102x3 mm
BISCFCEM4353IS*	IS304	102x89x3 mm

Product code	Finishes	Dimensions
BISCFCEM433IS01*	IS201	102x76x3 mm
BISCFCEM443IS01*	IS201	102x102x3 mm

* Includes screws for timber doors

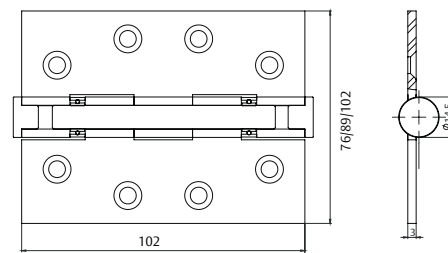
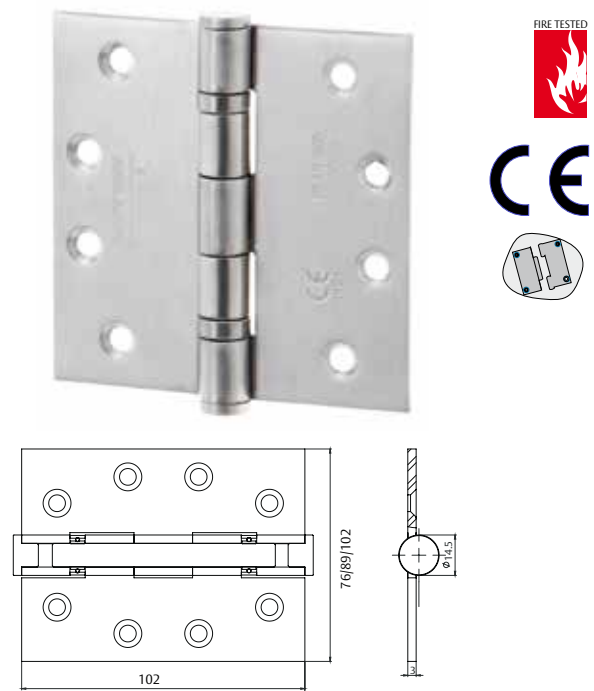

UL Certified Stainless Steel hinges

- » UL10C certified
- » SS304 hinges, with 2 or 4 bearing for fire-break doors
- » 180 minutes Fire-resistance
- » Very high corrosion resistance (Grade 4)
- » Reversible.
- » SS screws included

Reference	Dimensions
BISUL4543IS	114x102x3 - 2 bearing
BISULM454534IS*	114x114x3,4, 2 bearing, metallic doors
BISUL44543IS	114x102x3 - 4 bearing
BISULM45434IS*	114x102x3,4, 2 bearing, metallic doors

* Screws for timber and metal door/frames.

