



Traffic System

Heavy duty handles for high traffic doors



ASSA ABLOY

Experience a safer
and more open world

Traffic, a system for heavy duty doors

Unbreakable mechanism

These handles gather the highest performances related to resistance, safety, flexibility and high quality materials, in addition to a system un-removable unique in the marketplace that ensures the longest durability. That is why this is the most convenient solution for heavy and high traffic doors.

Overpass 1.000 Nw of axial strength in test performed!

The mechanism is fixed to the handle and escutcheon with an internal nut. The circlip used but some handles in the marked is avoided. This works as a “sandwich” which provides a high level of consistency. All the parts are joined by the special M14 x 1 nut, which ensures that never the handle will be removed from the door.

Overpass 1.000 Nw of axial strength in test performed!

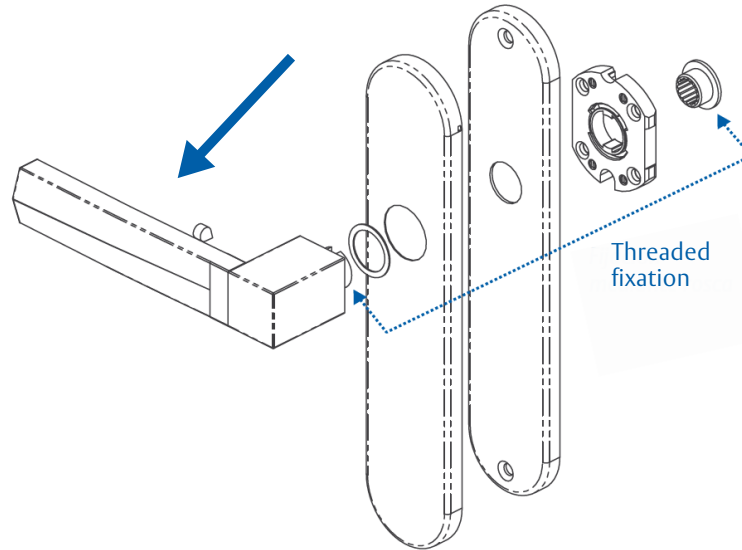

Scan the QR code or click with the mouse to access the Traffic 3D viewer

Other main features

- These handles are manufactured in AISI316L, also known as “Marine Stainless Steel”, due to its excellent performance in saline and aggressive atmospheres.
- Tested to 1 million cycles. Ideal for heavy, high traffic doors.
- Fixing bolts with anti-loose treatment.
- Passing through-bolts for doors up to 70 mm thick.
- Easy hand reversibility which allows that a right hand handle can be converted into a left one, and vice versa.
- Compatible with TESA ASSA ABLOY Exit Panic Devices.
- Marked with TESA ASSA ABLOY distinctive,



Scan the QR code or click with the mouse to access the Traffic website section.

Classification according to EN 1906

Category of use	Durability	Fire Resistance	Corrosion Resistance
Grade 3	Grade 7	Grade B	Grade 5
High frequency of non-motivated people, stadiums, schools, etc.	1.000.000 cycles.* <i>*The standard sets 200,000 for grade 7.</i>	Suitable for RF doors according to EN 1634-1 	Very high corrosion resistance.

A careful aesthetics

7 designs

As a consequence of an intense study, the original aesthetics of these handles has been the outcome of the combination of taste and tendencies showed by the different actors of the market of high standards and quality handles.

Finishes



Stainless Steel



AntiMicrobial Black



Antimicrobial Stainless Steel



AntiMicrobial Titanium



Tundra



Sena-I



Cubo-I



Xara



Zafira



Hamat



Vector

5 configurations

Rosette



Long plate

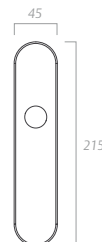
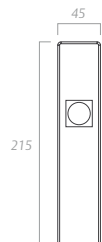

Square plate

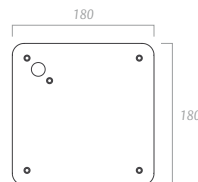

Complements



Cylinder keyhole for Tundra



Thumbturn for Tundra



Cylinder keyhole for Cubo-I, Sena-I, Xara, Zafira, Hamat and Vector



Thumbturn for Cubo-I, Sena-I, Xara, Zafira, Hamat and Vector

How does it work?

The coating of silver ions and Zeolite of TESA ASSA ABLOY's antimicrobial handle releases the silver ions gradually, which act on the bactericidal strains by dismantling their metabolism and inhibiting their cell division.



Laboratories and bodies that certify the antimicrobial properties of our handles:



- Tecnia Research & Innovation, San Sebastian
- University of Pavia, Italy
- Law Laboratories Ltd., Birmingham
- Instituto Sabater, Barcelona
- Chelab Laboratory, Italy
- University of Navarra, Pamplona

It meets Standard:

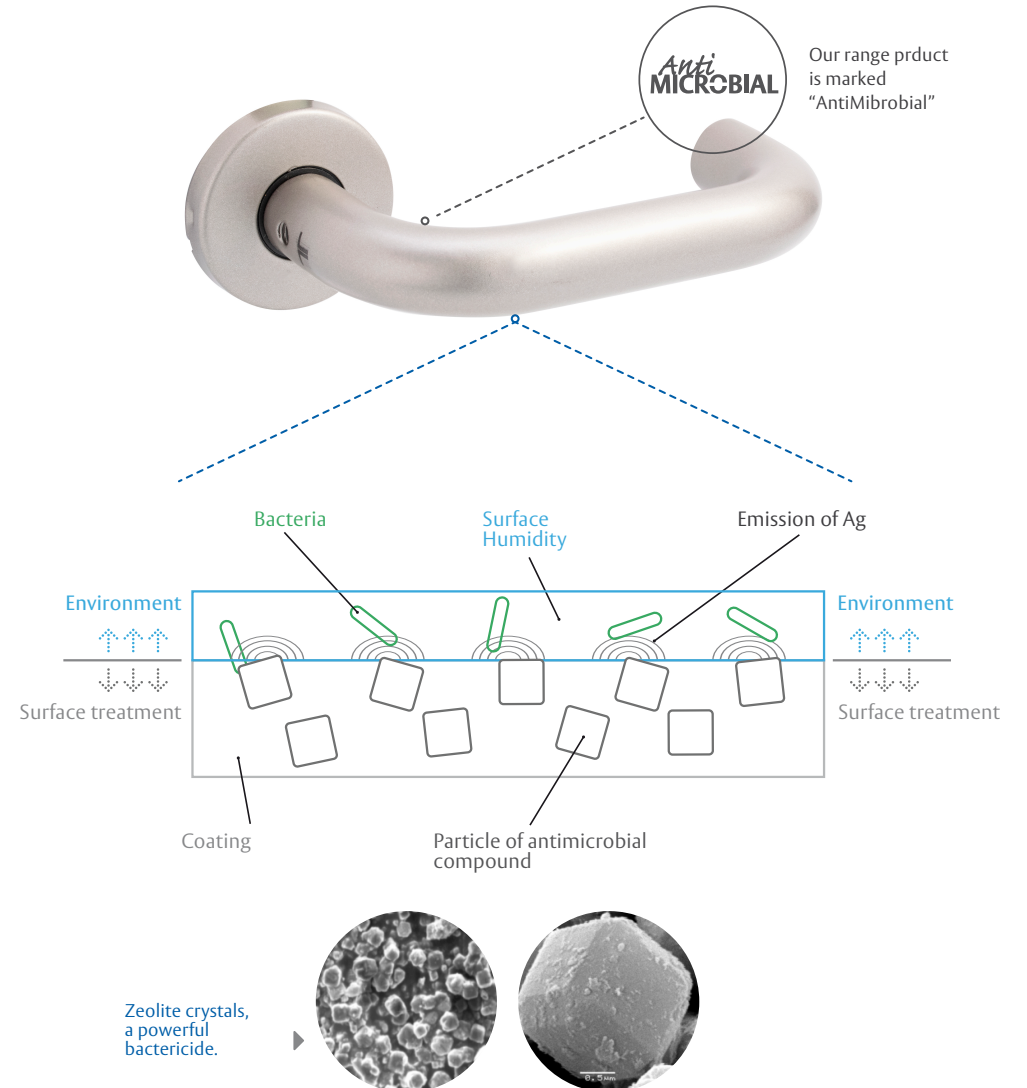
ISO 22196:2011 / JIS Z 2801:2000



Outside handles for panic exit devices

				
		Sena-I	Cubo-I	Tundra
Rim models		SI1912	CI1912	TU1912
Mortice models	2030 lock	SIDF32	CIDF32	TUDF32
	CF60 lock	SIDF92	CIDF92	TUDF92

Traffic System

Maximum resistance, security and durability, even in aggressive atmosphere.



this is the most convenient solution for heavy and high traffic doors

TESA ASSA ABLOY

Talleres de Escoriaza, S.A.U.
Barrio Ventas, 35
E-20305 Irun · Guipúzcoa

Tel.: +34 943 669 100

Fax: +34 943 633 221

www.tesa.es



ASSA ABLOY

Experience a safer
and more open world