

# ABLOY® CY403

## Round ANSI cylinder



**Product description**

Used with rim and mortice lock cases. Length: 1¼ inch.

**Overview of Advantages**

- Strong burglary protection
- Suitable for both outer and inner door use
- Adjustable during installation to match different door thicknesses
- Several plating options

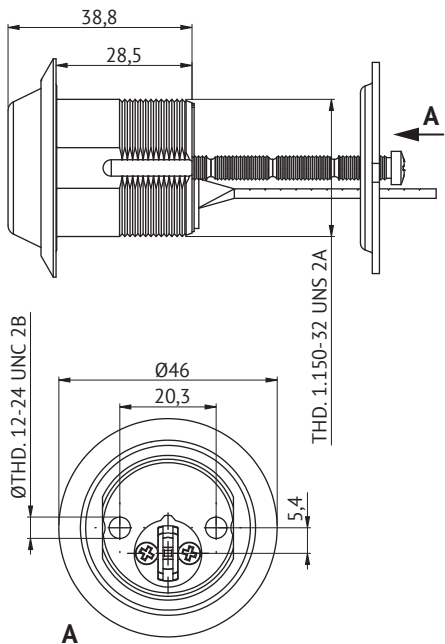

**Technical data**

Available key systems	ABLOY PROTEC, ABLOY PROTEC², ABLOY NOVEL
Material	Case hardened steel
Available plating options	Bright chrome (Cr), Satin chrome (HCr), Brushed nickel (NiHa)
Cylinder ring diameter	46 mm
Cylinder ring height	38.8 mm
Suitable for fire doors	Yes
ANSI Standard	UL-437 LISTED
Weight	0.25 kg

This content is protected by Intellectual Property Rights Laws. The title to the content shall not pass to you, and instead shall remain with Abloy Oy or a third party holding the title. Abloy develops continuously the products and solutions offered. Therefore, the information contained in the document is subject to change without notice. ABLOY PROVIDES THIS CONTENT ON AN "AS IS" BASIS WITHOUT ANY WARRANTIES OF ANY KIND, EXPRESS, IMPLIED, OR STATUTORY."

